

KINGSFORD SMITH DRIVE UPGRADE

Community Notice

April 2018

Changed traffic and pedestrian conditions

As part of the Kingsford Smith Drive upgrade, public utility services are being relocated and where required, replaced, to ensure these services continue to meet the needs of the local community.

From **Sunday 29 April 2018 for a period of up to four months**, barriers will be installed on the northern side of Kingsford Smith Drive between Hunt Street and Cooksley Street to enable the installation of underground services. Left turn access from Kingsford Smith Drive into Cooksley Street will be maintained.

These changes are required to provide the necessary space to safely relocate public utility services and enables the project team to carry out the majority of work during the day to minimise the impact of consecutive night shifts on local residents.

Pedestrian access will be maintained around the worksite under the direction of traffic control, and driveway access will be maintained at all times. Additional signage will be installed to assist motorists and pedestrians in navigating the area.

Outbound bus stop changes

From **Sunday 29 April 2018 for a period of up to four months**, the outbound bus stop on Kingsford Smith Drive at Cooksley Street (stop 13/14) will be closed. Regular bus services will be accessed from stop 15 on Kingsford Smith Drive at Toorak Road.

In the event of wet weather or unforeseen circumstances, this closure may be extended to allow the work activity to be completed safely.

The Lendlease Community Relations team will work closely with affected tenants and property owners to minimise impacts throughout construction.

Why are these works happening?

The Kingsford Smith Drive upgrade will improve the capacity of the road to meet the future needs of the traffic network on one of Brisbane's busiest roads.

The upgrade involves widening Kingsford Smith Drive from four to six lanes between Theodore Street at Eagle Farm and Cooksley Street at Hamilton. It also includes improvement works between Cooksley Street and Breakfast Creek Road at Albion.

Phone: 1800 084 383 (24 hours)
Email: info@ksdupgrade.com
Web: www.ksdupgrade.com.au
Visit: Kingsford Smith Drive upgrade Visitor Centre
605 Kingsford Smith Drive, Hamilton, 4007
Post: GPO Box 2777, Brisbane QLD 4001

Designed and constructed by

lendlease

An initiative of



Dedicated to a better Brisbane

Changed traffic and pedestrian conditions

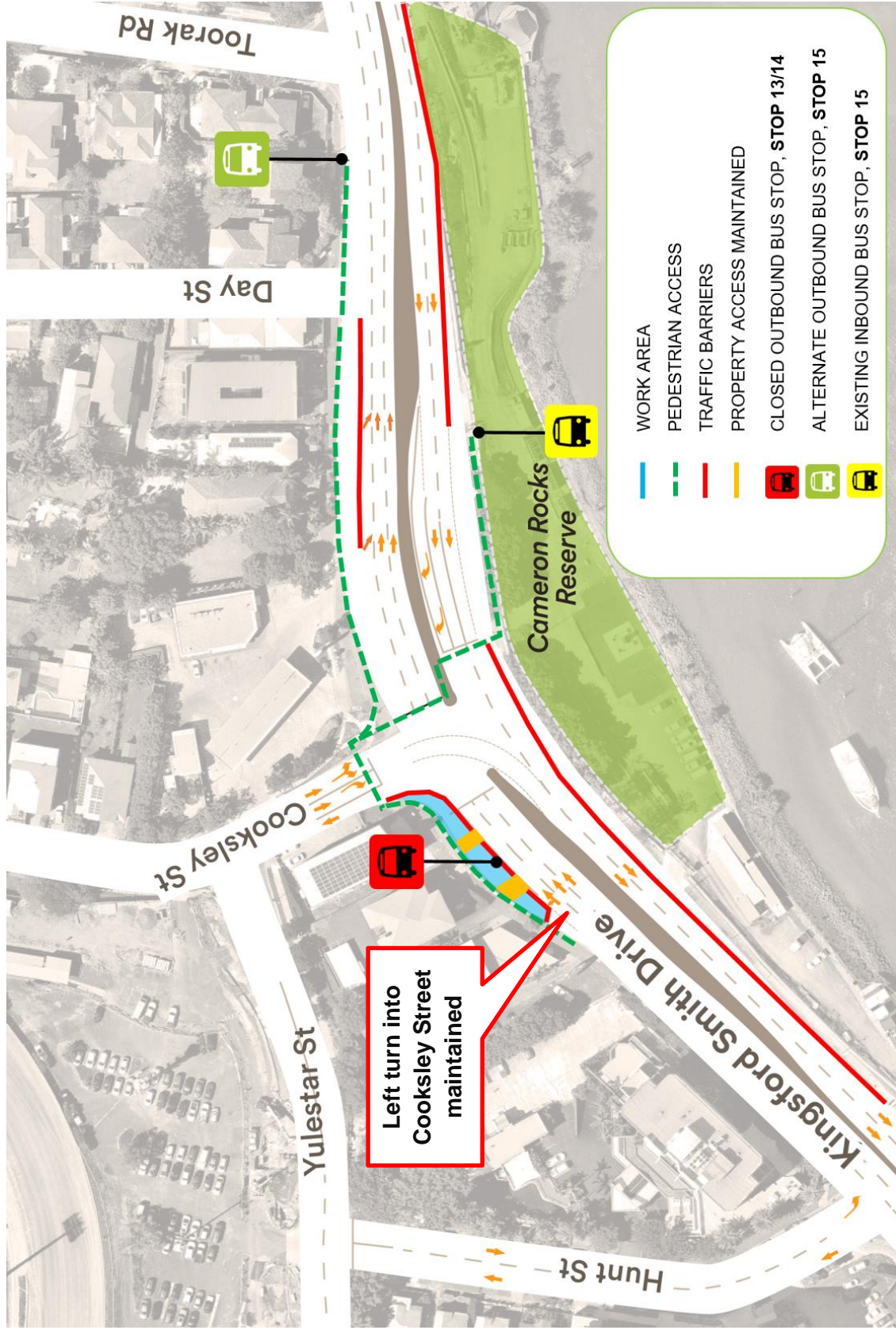

More information

For more information regarding planned construction activities, please contact the team on 1800 084 383 or email info@ksdupgrade.com.au

Phone: 1800 084 383 (24 hours)
 Email: info@ksdupgrade.com
 Web: www.ksdupgrade.com.au
 Visit: Kingsford Smith Drive upgrade Visitor Centre
 605 Kingsford Smith Drive, Hamilton, 4007
 Post: GPO Box 2777, Brisbane QLD 4001

Designed and constructed by

lendlease

An initiative of



Dedicated to a better Brisbane